

# WP310 series



- Small size, large flow, stable transmission
- Transparent flip cover design for easy viewing of the hose
- The pump head is made of PPS+PC material, corrosion resistance and high strength
- Roller POM material, excellent heat resistance, wear resistance and stability
- Self-adaptive spring tube clip, slow down hose wear, longer life and wider adaptation
- Suitable for various types of hoses and power configurations
- Support OEM customization

Typical Application: Used in dishwashers, fermentation tanks, environmental protection equipment

Max Flow: 1100mL/min

Max speed: 300rpm

Model	Pump Head	Motor	Voltage	Max Speed	Max Flow(mL/min)						
					13#	14#	19#	16#	25#	17#	18#
ACM116-1	WP310	PMSM	AC220V	100	6	26	50	80	170	290	366
ACM116-2	WP310	PMSM	AC110V	100	6	26	50	80	170	290	366
OEM216-1	WP310	DC Gear	DC12V	300	20	80	150	240	510	870	1100
OEM216-2	WP310	DC Gear	DC24V	300	20	80	150	240	510	870	1100
UCP316-A2	WP310	Stepper		300	20	80	150	240	510	870	1100
UCP316-B1	WP310	Stepper		300	20	80	150	240	510	870	1100

Note: The test environment for flow data is normal temperature and pressure, and the test fluid is water. The values are for reference only, please refer to the actual situation.

ACM116 (Max flow 366mL/min)

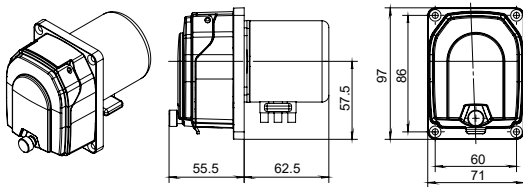

OEM216 (Max flow 1100mL/min)

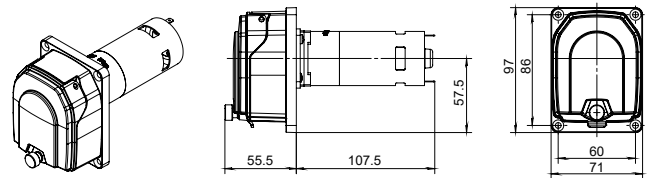

UCP316-A2 (Max flow 1100mL/min)

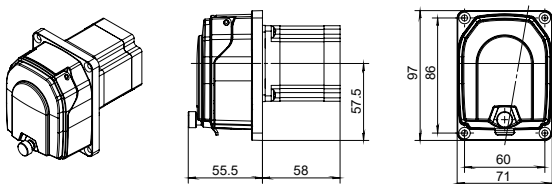

(Unit: mm)